



**Electrolux**  
PROFESSIONAL

**Eco Preparation**  
**1600 mm Storage Cabinet with**  
**sliding doors h. 1600**

ITEM # \_\_\_\_\_

MODEL # \_\_\_\_\_

NAME # \_\_\_\_\_

SIS # \_\_\_\_\_

AIA # \_\_\_\_\_



132888 (SAS16N)

Storage Cabinet, h. 1600mm,  
with 3 shelves and 2 sliding  
doors, 1600mm

**Short Form Specification**

Item No. \_\_\_\_\_

Constructed in stainless steel. Intermediate shelves, supports and inner doors in stainless steel. Handles are formed by a fold in the sliding doors. Adjustable feet.

**Main Features**

- Handles in stainless steel for better hygiene and reliability.
- Sturdiness, stability and reliability of table accurately tested.

**Construction**

- Handles directly built into the sliding doors.
- Constructed entirely in stainless steel to offer maximum durability.
- Base panel has 40mm high profile, is 8/10 in thickness with upturned edges and bar reinforcement. It is welded to legs for further structure reinforcement.
- Two double-walled sliding doors flush fitting to the front of the frame can be removed to facilitate cleaning of the cupboard interior.
- 304 AISI stainless steel feet, 150 mm high and 54 mm in diameter, adjustable by -35/+25 mm.

**Optional Accessories**

- Wheel kit for cupboards, 4 PNC 855299  wheels (2 with brakes), D=1000 mm

APPROVAL: \_\_\_\_\_



Experience the Excellence  
[www.electroluxprofessional.com](http://www.electroluxprofessional.com)

### Key Information:

Cabinet width:		
132888 (SAS16N)	1545 mm	
Cabinet depth:	645 mm	
Cabinet height:	1365 mm	
External dimensions, Width:	1600 mm	
External dimensions, Depth:	700 mm	
External dimensions, Height:	1600 mm	
Net weight:	123 kg	

Front

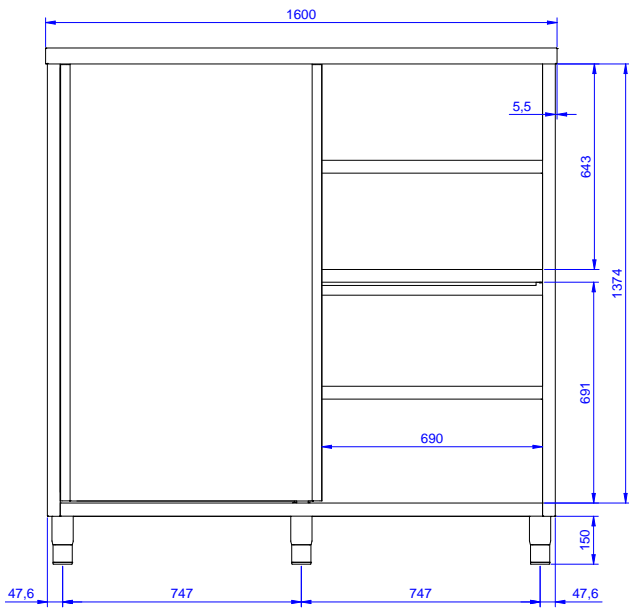

Side

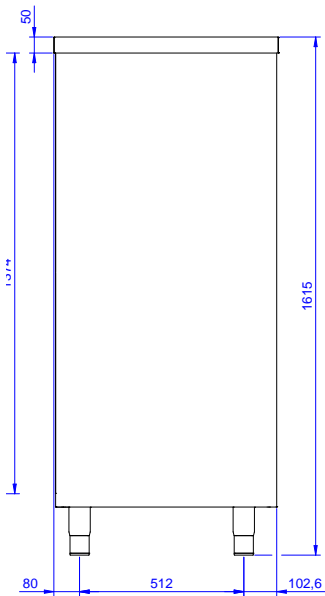

Top

